

**DANCOVER<sup>®</sup>**

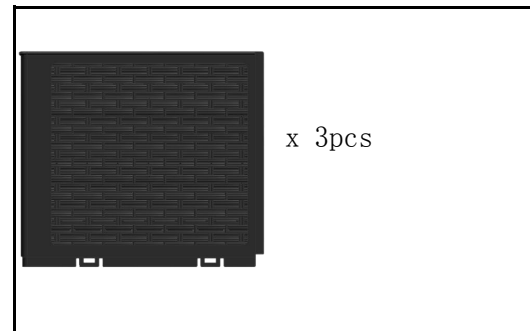

Manual  
for  
Plant Tower  
0,25x0,25x1,29m

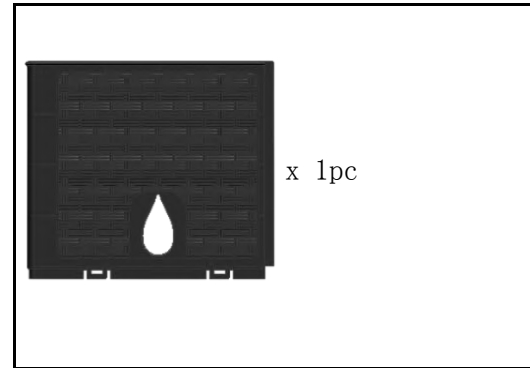
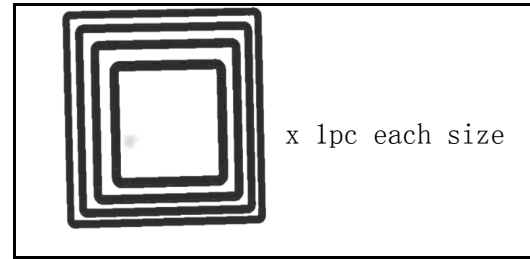
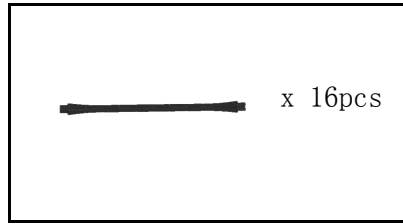

1. Connect side panel

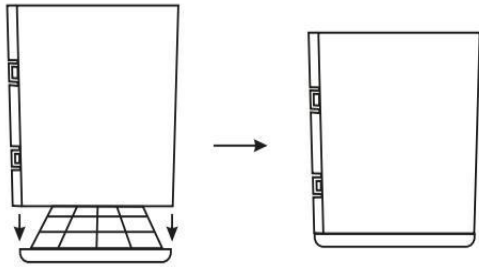

2. 4 panels connected

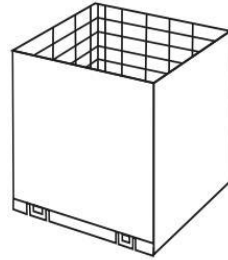

3. Connect the pannels with bottom

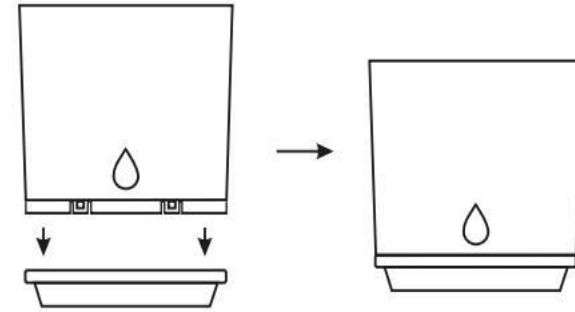

4. Put waterproof pad

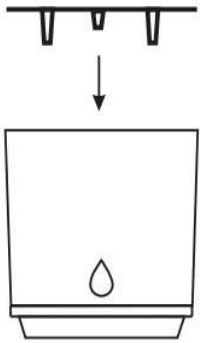

5. Install a watering hole for the pot

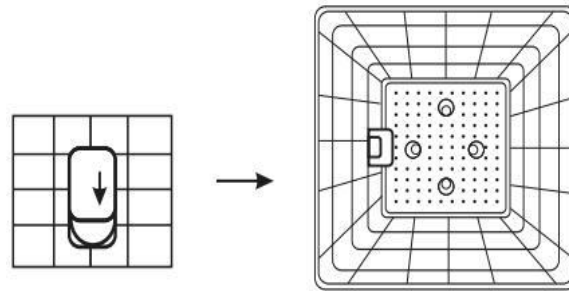

6. Attach 4-vertical supports to the pot

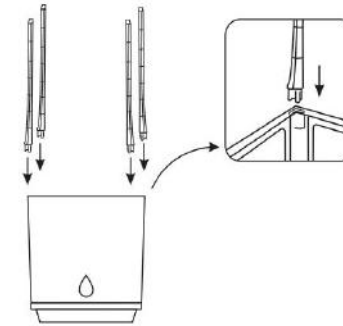

7. Place the largest square bracket on four vertical supports

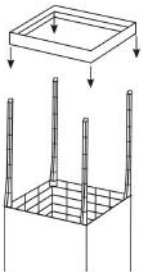

8. Repeat the procedure through successive levels.

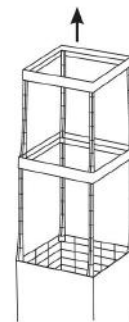

# DANCOVER<sup>®</sup>

.com

## Contact information

Austria



Belgium



Croatia



Denmark



Estonia



Finland



France



Germany



Ireland



Italy



Latvia



Lithuania



Nederland



Norway



Poland



Portugal



Spain



Sweden



Switzerland



UK



For more information please visit: [www.dancovershop.com](http://www.dancovershop.com)